

## Maintenance of Traffic Application Form

Date 3/11/21 Broward County Permit Number (if required) \_\_\_\_\_  
 Applicant/Authorized Agent Kiewit Infrastructure South Co. Address 1580 Sawgrass Corporate Pkwy.  
 City Sunrise State FL Zip 33323 Office # 954-835-2228  
 Mobile # 832-418-4567 E-mail Matthew.Young1@Kiewit.com  
 Full name and Mobile # of 24 hr Contact Person Matthew Young; C: 832-418-4567  
 Name of Applicant/Authorized Agent Working under this Approval: \_\_\_\_\_  
Kiewit Infrastructure South Co.

Location of Project: SE 5th Avenue Bridge City: Pompano Beach  
 Project Boundaries, From 1100 SE 5th Avenue To 1000 SE 12th Street  
 Description of Work: Remove and replace existing SE 5th Avenue Bridge in Pompano Beach, Florida.

Proposed Start Date: 3/25/21 Proposed Completion Date: 12/31/21

Authorized Contractor's Representative

BRUCE APPEGATE [Signature] 3/11/2021  
 (Print Name) (Signature) (Date)

A copy of the certification card(s) shall be included with every MOT Plan

<u>Matthew Young</u>	<u>Advanced</u>	<u>Matthew Young</u>	<small>Digitally signed by Matthew Young DN: C=US, E=moung613@gmail.com, CN=Matthew Young Date: 2021.03.11 14:36:44-05'00'</small>
(Print Name of Certified Person Submitting MOT)	(Level)	(Signature)	(Date)
<u>Matthew Young</u>	<u>Advanced</u>	<u>Matthew Young</u>	<small>Digitally signed by Matthew Young DN: C=US, E=moung613@gmail.com, CN=Matthew Young Date: 2021.03.11 14:37:49-05'00'</small>
(Print Name of Certified Person Setting Up MOT)	(Level)	(Signature)	(Date)
<u>Matthew Young</u>	<u>Advanced</u>	<u>Matthew Young</u>	<small>Digitally signed by Matthew Young DN: C=US, E=moung613@gmail.com, CN=Matthew Young Date: 2021.03.11 14:38:24-05'00'</small>
(Print Name of Certified Person Maintaining MOT)	(Level)	(Signature)	(Date)
<u>Matthew Young</u>	<u>Advanced</u>	<u>Matthew Young</u>	<small>Digitally signed by Matthew Young DN: C=US, E=moung613@gmail.com, CN=Matthew Young Date: 2021.03.11 14:38:18-05'00'</small>
(Print Name of Certified Person in Charge of	(Level)		
Flagging Operation MOT)			

**BROWARD COUNTY**  
Traffic Engineering Division  
**M.O.T. PLANS**

The following document will be required prior to the approval of the

A filled out and signed form of ACCEPTANCE OF TRAFFIC SIGNAL MAINTENANCE AND TIMING BY CONTRACTOR DURING CONSTRUCTION AND BURN-IN PERIOD. The form can be downloaded under the category of Maintenance of Traffic in the webpage of

<http://www.broward.org/Traffic/Pages/Publications.aspx>

G:\STUDIES\MOT\MOT Application Form\MOT Application Form 11-15-18.doc

Page 3

**APPROVED**

By [Signature]

Date March 15, 2021

Remarks Set up in accordance with FDOT/ MUTCD Design Standards. City approval required.

Work hours Mon-Fri 9am to 4pm



March 11, 2021

**Broward County Traffic Engineering Division**  
**2300 W. Commercial Blvd**  
**Fort Lauderdale, FL 33309**

Attn: BCTED

Project: SE 5<sup>th</sup> Avenue Bridge Replacement  
COPB 19360

Subject: MOT Plan Submission

Mr. Philippe,

This letter serves to inform you that Kiewit Infrastructure South Co. (KISC) intends to perform a closure of the SE 5<sup>th</sup> Avenue Bridge in Pompano Beach, FL. Please see the attached sheets for additional information regarding the MOT Plan that will be utilized during the construction.

Please note the following:

- KISC intends to follow the attached traffic control plan labeled *Temporary Traffic Control Plan – Detour*.
- The applicable index is MUTCD Typical Application 20.
- The attached detour will be utilized for all phases of construction.
- Portable Changeable Message Signs will be placed on Cypress Creek Rd. a minimum of 7-days in advance of commencement of construction.

If you have any questions, please feel free to reach me at 832-418-4567.

Sincerely,

Matt Young

Cc: Job File



This Certifies that  
**MATTHEW YOUNG**

Has Completed a Florida Department of Transportation Approved  
Temporary Traffic Control (TTC) Advanced Course.

Date Expires: 02/28/2024

Certificate # 61013

Instructor: Jeremiah McCarthy FDOT Provider # 140

Metro Florida Safety Council  
Phone: 954-603-1900  
Tri-County  
Dade, Broward, Palm Beach,  
[metrofloridasafetycouncil.com](http://metrofloridasafetycouncil.com)  
[mlyons@metrofloridasafetycouncil.com](mailto:mlyons@metrofloridasafetycouncil.com)



# Certificate of Completion

**MATTHEW YOUNG**

**Has Completed a Florida Department of  
Transportation Approved Temporary Traffic  
Control (TTC) Advanced Course.**

**02/28/2024**

Date Expires

**140**

FDOT Provider #

**Jeremiah McCarthy**

Instructor

**61013**

Certificate #



Metro Florida Safety Council  
Tri-County  
Dade, Broward, Palm Beach,  
[metrofloridasafetycouncil.com](http://metrofloridasafetycouncil.com)  
[mlyons@metrofloridasafetycouncil.com](mailto:mlyons@metrofloridasafetycouncil.com)



For more information about Temporary Traffic  
Control (TTC) or to verify this certificate

[www.motadmin.com](http://www.motadmin.com)



## Project Location

Google Maps  $26^{\circ}12'58.8''\text{N}$   $80^{\circ}06'57.2''\text{W}$

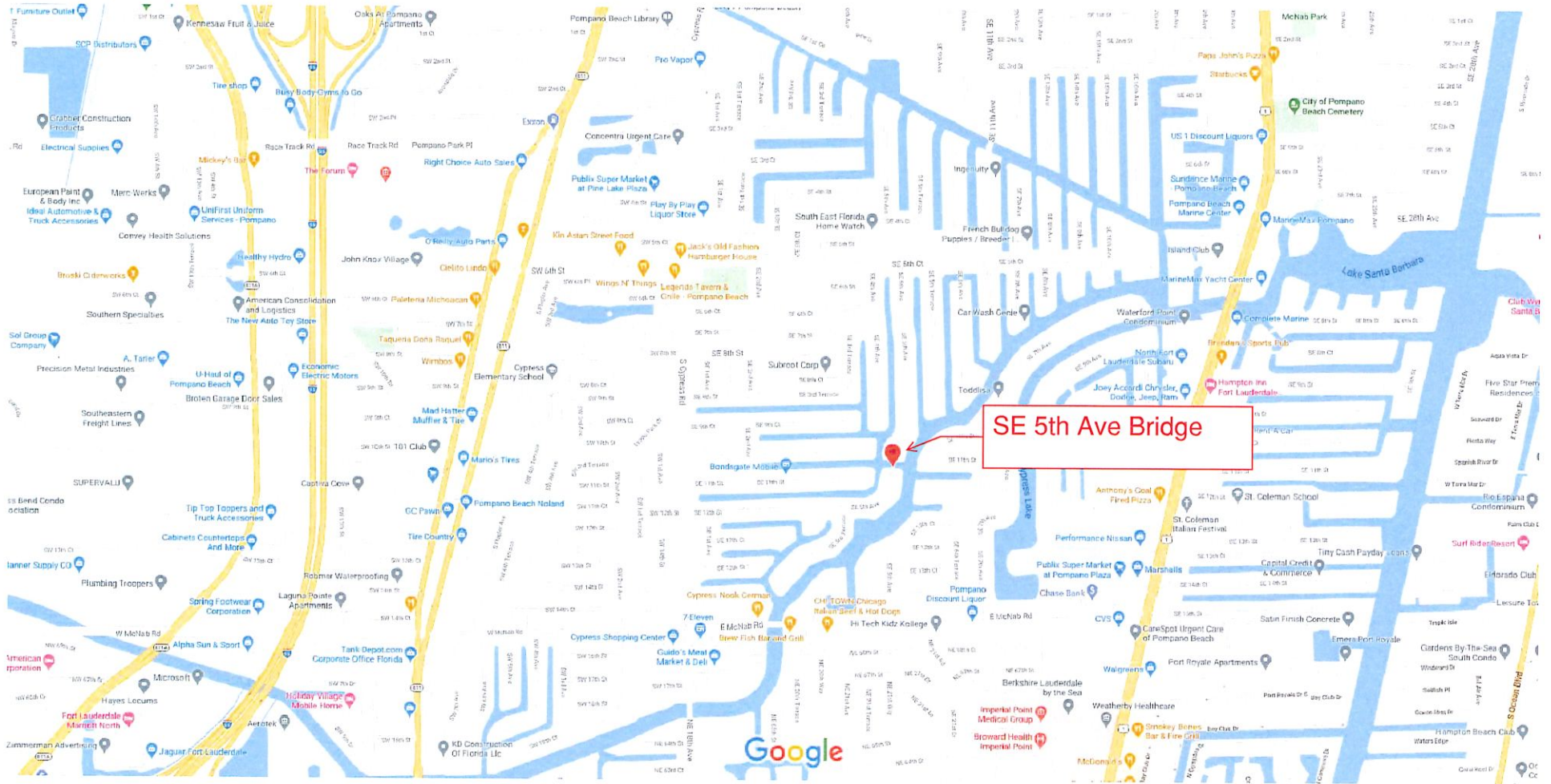

Map data ©2021 500 ft









**Table 6H-2. Meaning of Symbols on Typical Application Diagrams**

	Arrow board		Shadow vehicle
	Arrow board support or trailer (shown facing down)		Sign (shown facing left)
	Changeable message sign or support trailer		Surveyor
	Channelizing device		Temporary barrier
	Crash cushion		Temporary barrier with warning light
	Direction of temporary traffic detour		Traffic or pedestrian signal
	Direction of traffic		Truck-mounted attenuator
	Flagger		Type 3 barricade
	High-level warning device (Flag tree)		Warning light
	Longitudinal channelizing device		Work space
	Luminaire		Work vehicle
	Pavement markings that should be removed for a long-term project		

**Table 6H-3. Meaning of Letter Codes on Typical Application Diagrams**

Road Type	Distance Between Signs**		
	A	B	C
Urban (low speed)*	100 feet	100 feet	100 feet
Urban (high speed)*	350 feet	350 feet	350 feet
Rural	500 feet	500 feet	500 feet
Expressway / Freeway	1,000 feet	1,500 feet	2,640 feet

\* Speed category to be determined by highway agency

\*\* The column headings A, B, and C are the dimensions shown in Figures 6H-1 through 6H-46. The A dimension is the distance from the transition or point of restriction to the first sign. The B dimension is the distance between the first and second signs. The C dimension is the distance between the second and third signs. (The "first sign" is the sign in a three-sign series that is closest to the TTC zone. The "third sign" is the sign that is furthest upstream from the TTC zone.)

**Table 6H-4. Formulas for Determining Taper Length**

Speed (S)	Taper Length (L)
40 mph or less	$L = \frac{WS}{15}$
45 mph or more	$L = \frac{WS}{10}$

Where: L = taper length in feet  
W = width of offset in feet  
S = posted speed limit, or off-posted speed prior to work starting operating speed in mph

**BROWARD COUNTY**  
**Traffic Engineering Division**  
**M.O.T. PLANS**

**APPROVED**

By

Date March 15, 2021

Remarks Set up in accordance with FDOT/MUTCD Design Standards. City approval required.

*Work hours Mon-Fri 9am to 4pm*



**Notes for Figure 6H-20—Typical Application 20**  
**Detour for a Closed Street**

**Guidance:**

1. *This plan should be used for streets without posted route numbers.*
2. *On multi-lane streets, Detour signs with an Advance Turn Arrow should be used in advance of a turn.*

**Option:**

3. Flashing warning lights and/or flags may be used to call attention to the advance warning signs.
4. Flashing warning lights may be used on Type 3 Barricades.
5. Detour signs may be located on the far side of intersections. A Detour sign with an advance arrow may be used in advance of a turn.
6. A Street Name sign may be mounted with the Detour sign. The Street Name sign may be either white on green or black on orange.

**Standard:**

7. **When used, the Street Name sign shall be placed above the Detour sign.**

**Support:**

8. See Figure 6H-9 for the information for detouring a numbered highway.

BROWARD COUNTY  
 Traffic Engineering Division  
 M.O.T. PLANS

**APPROVED**

By 

Date March 15, 2021

Remarks Set up in accordance with FDOT/  
 MUTCD Design Standards. City approval required.

*Work hours Mon-Fri 9am to 4pm*

**BROWARD COUNTY**  
Traffic Engineering Division  
**M.O.T. PLANS**

**Figure 6H-20. Detour for a Closed Street (TA-20)**

**APPROVED**

By 

Date March 15, 2021

Remarks Set up in accordance with FDOT/  
MUTCD Design Standards. City approval required.

Work hours Mon-Fri 9am to 4pm

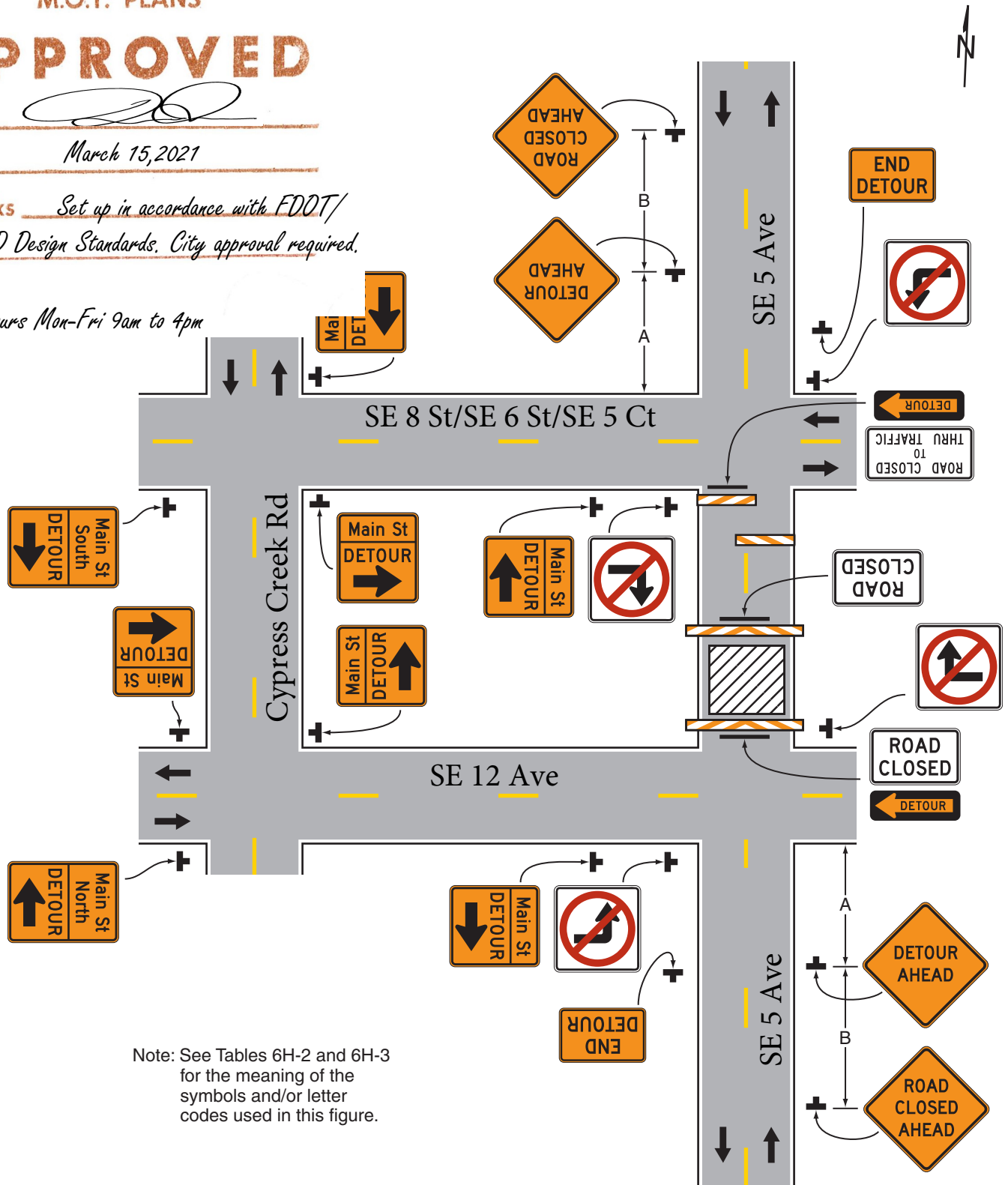

Note: See Tables 6H-2 and 6H-3 for the meaning of the symbols and/or letter codes used in this figure.

**Typical Application 20**